

LeakSmart by Waxman™

**Leak Detection & Automatic
Water Shut-off System**
Water Heater Kit - 8810200

**Installation and
Operating
Manual**



© 2014 Waxman Consumer Products

LeakSmart by Waxman™

Congratulations on your purchase of a LeakSmart by Waxman™ Water Heater Leak Detection kit. LeakSmart is a patented, electronic water leak detection and automatic water shut-off system for water leaks caused by a leaking water heater.

This product has been designed to automatically shut-off the water supply to the water heater after it has detected a water leak.

To ensure proper installation and to maximize the performance of your LeakSmart water leak detection system, please read this entire manual thoroughly before installing or operating LeakSmart.

PLEASE READ CAREFULLY BEFORE PROCEEDING:

If a leak is detected, the LeakSmart Valve will shut off the water going to the water heater. This will stop the continuous flow of water from the water supply to the water heater. However, all or some of the water that is already in the water heater may still leak out onto the floor.

NOTE: This installation and operating manual contains important information about the operation of the unit. If you are installing this unit for use by others, we recommend you leave this manual – or a copy of it- with the user.

2.

LeakSmart by Waxman™

Water Heater Kit - Model 8810200

FEATURES:

- Electronic LED Control Panel has easy to read and use lighted function buttons
- AC power with battery back-up – for continued operation in the event of power outages
- Lead free compliant, full - port motorized brass water ball valve
- Valve automatically shuts-off the water supply when a leak is detected
- Automatic monthly maintenance cycling of the valve for reliable, continuous operation
- Valve can be opened and closed with the touch of a button
- Activates an audible alarm when a leak is detected
- Mute button to silence the audible alarm
- Can be reset and reused continuously with the touch of a button
- Can be tested at any time with the touch of a button
- Can accommodate additional Water Leak Sensors (sold separately)
- Two (2) Year Limited Warranty

3.

This Package Contains:

- A (1) LeakSmart Motorized Brass Water Ball Valve (3/4" FIP x 3/4" MIP)
- B (1) LED Control Panel
- C (1) Water Leak Sensor with paper sleeve
- D (1) AC Power Adaptor (6 ft. length)
- E (1) Wire Harness
- F (1) Hook & Loop Mounting Pad
- G (2) Mounting Screws with Anchors



Check to make sure everything in the package matches the Contents Listing above.
Read the instructions thoroughly before installing or operating the LeakSmart system.

WARNING: Do not put finger(s) inside the LeakSmart Valve. Risk of serious injury may occur.

CAUTION: Do not grip plastic motor drive for leverage when tightening the LeakSmart Valve.

WARNING: LeakSmart is for indoor use only! Do not install LeakSmart outdoors!

WARNING: For use with water only. **Do not install on gas line.**

WARNING: Do not use this product on fire suppression systems or fire sprinkler water lines.

4.

STOP: Read the instructions thoroughly before installing or operating the LeakSmart System. You may need to purchase additional fittings to install the LeakSmart Valve. If you are not sure how to install the LeakSmart Valve to your existing water line, we recommend that you contact a licensed Plumber.

Preparation

Step 4 instructs you to install the LeakSmart Valve (3/4" FIP x 3/4" MIP) between the rigid water line coming off the manual cold water valve and the water heater. Most rigid lines will be copper. Evaluate your line and determine which size adapter fitting you will need (the most common one will be 3/4" solder x 3/4" male adaptor and 3/4" solder x 3/4" female adaptor). Then determine what size union you will need between the LeakSmart Valve and the water heater. Check your local plumbing codes for proper installation.

CAUTION: Make sure the LeakSmart Valve is not connected to the adaptor fitting(s) when soldering.

5.

Installation Instructions:

1. Shut off main water supply valve.

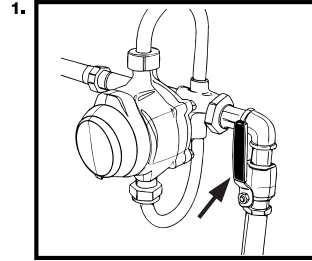

2. Open faucet nearest water heater to relieve water pressure.

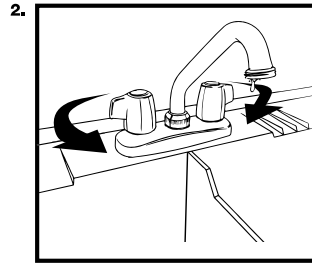

6.

Installation Instructions:

3. If you have a manual water shut-off valve on the cold water line that supplies water to the water heater, shut it off. Note that the top of the water heater will usually be marked "Cold" or "Inlet" at the point where the cold water line is connected.

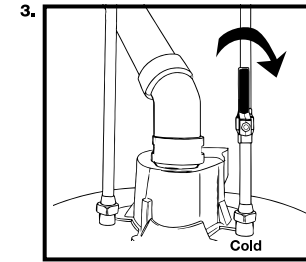

4. Position the LeakSmart Valve so that the arrow on the side of the valve is pointing to the water heater. Install the LeakSmart Valve on the "Cold" or "Inlet" water supply line between the manual shut-off valve and the water heater.

NOTE: The LeakSmart Valve should be installed within 2 feet of the water heater so that the Leak Sensor can lay flat on the floor.

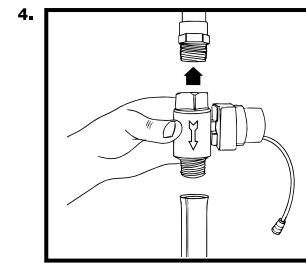

7.

Installation Instructions:

5. Mount the LeakSmart Control Panel in an easily accessible location within 30 inches of the LeakSmart Valve. You may mount the panel using the screws and anchors or Hook & Loop Mounting Pad provided. When using the Hook & Loop Mounting Pad, make sure the adhesive is put on a clean, dry surface.

NOTE: Depending on the location you pick, and the distance between the Control Panel and the LeakSmart Valve, you may need to purchase a LeakSmart Control Panel to Valve Extension Wire, Model # 8821200 (sold separately, available where you purchased your LeakSmart System). The extension wire can extend the length of the LeakSmart valve wire by approximately 9 feet.

6. With the contacts of the wire harness connector facing you, plug the 4-pin connector end of the Wire Harness into the bottom of the Control Panel.

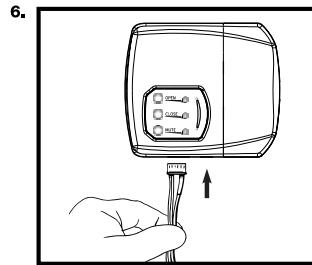
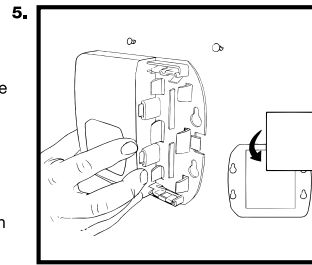

8.

Installation Instructions:

7. Take the short round wire coming from the Control Panel and plug it into the wire coming from the LeakSmart Valve. Make sure the arrow on the side of each plug lines up with each other.

NOTE: The LeakSmart Water Leak Sensor comes with a paper sleeve. If the Leak Sensor is going to be placed in a metal water heater pan, make sure you leave the paper sleeve on. If the Leak Sensor makes contact with metal, it will signal the LeakSmart Valve to shut off. The paper sleeve acts as a barrier between the Leak Sensor and the metal. When the paper sleeve becomes wet, it will signal the LeakSmart Valve to shut off. If the Leak Sensor will not be contacting metal, you may remove the paper sleeve.

8. Connect plug on end of long flat wire coming from Control Panel to either set of prongs on the Leak Sensor, pushing until plug snaps in place. Then place Leak Sensor on the floor next to the water heater, preferably on the side that is in line with the floor drain.

NOTE: Additional Water Leak Sensors (sold separately) can be connected together for added protection. For additional Leak Sensors, purchase LeakSmart Water Leak Sensor, Model #8820700 (available where you purchased your LeakSmart System).

CAUTION: Do not place Leak Sensor or cord in a walk way or other location that may cause someone to trip and fall.

9.

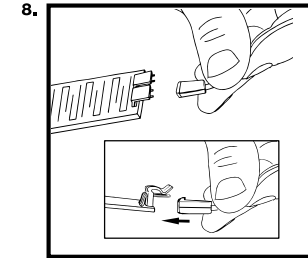
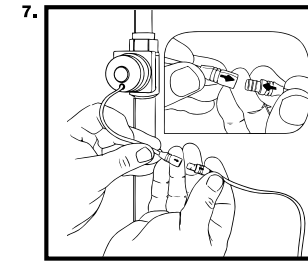

Installation Instructions

9. Plug the pin on the end of the AC Power Adaptor cord into the bottom of the Control Panel, and then plug the AC Power Adaptor into the nearest 110 volt wall outlet. Green indicator lights will start to flash, showing you have power. Note that a red low battery indicator light will also flash about every 30 seconds, and the unit will beep approximately once a minute until fresh batteries are installed.

NOTE: If a nearby wall outlet is not available you will need to purchase a thin low voltage LeakSmart AC Power Adaptor Extension Wire Model # 8821100. This extension wire is sold separately (available where you purchased your LeakSmart System). This wire extends the length of the AC Power Adaptor cord by approximately 9 feet.

NOTE: It is recommended that you do not plug the AC Power Adaptor into an extension cord. The LeakSmart kit comes with a 6 ft. AC Power Adaptor Cord. A 9 ft. AC Power Adaptor extension wire is also available (sold separately) that can provide a total length of 15 ft. for the AC Power Cord supply.

10. LeakSmart has a battery backup system that allows the unit to continue working in the event that you have a power outage. To set up the battery backup system, open the front of the Control Panel and install 4 fresh AA alkaline batteries (batteries not included). The low battery indicator light will now stop flashing and the beep will stop.

CAUTION: Replace batteries once a year or sooner as necessary. If batteries need to be changed sooner, a red low battery indicator light will flash, and a beep will sound.

10.

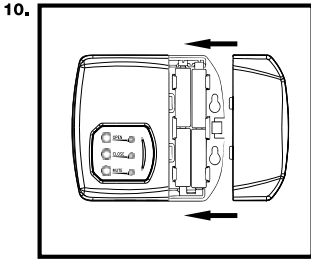
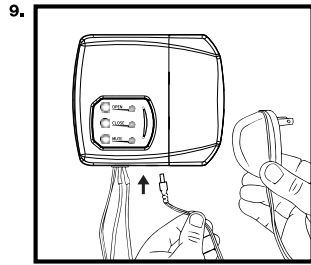

Installation Instructions

NOTE: The Control Panel will continue to beep approximately every minute until 4 fresh AA batteries are installed.

11. Shut off the previously opened faucet and turn on both valves that were shut off in steps 1 and 3. Check for leaks. Note that a green status light on the Control Panel will indicate whether the LeakSmart Valve is open or closed.

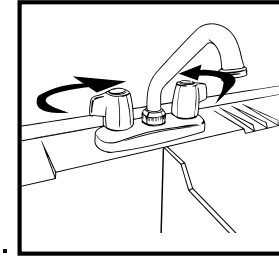

11.

11.

How to Operate your Control Panel

1. Top button opens LeakSmart Valve
2. Middle button closes LeakSmart Valve
3. Bottom button mutes the audible alarm that sounds when a leak is detected



Testing Your LeakSmart System

1. Push the Open button on the Control Panel to make sure LeakSmart Valve is open.
 - When the LeakSmart Valve is opening or closing, you will hear the valve motor operating for a few seconds.
2. Saturate a rag with water and squeeze over the Leak Sensor, or dip the Leak Sensor into a small bucket of water. Once the Leak Sensor is wet, it will signal the LeakSmart Valve to close, then an audible alarm will sound and a red light will flash.
 - Push the Mute button to silence the alarm, and note that the red light will continue to flash. This means the LeakSmart Valve is closed, and will remain closed until you push the Open button.
 - Before the LeakSmart Valve can be opened, the Leak Sensor needs to be dry. There is no need to unplug the AC Power Adaptor when drying off the Leak Sensor.
 - The water test can be done with the paper sleeve still on the Leak Sensor. Note that the paper sleeve is reusable, but once it gets wet, you will need to let it dry before placing it back on the Leak Sensor.

12.

Helpful Hints

- If the Leak Sensor paper sleeve is misplaced or becomes unusable, a paper towel can be used in its place.
- The Leak Sensor has two sets of prongs so you can connect additional Leak Sensors (sold separately). This is helpful when you have the Leak Sensor placed inside a metal water heater pan, but also want one outside the pan to sense other leaks such as a pressure relief valve failure. You can also link them together so they are positioned at different locations around your water heater.
- Once a month, the LeakSmart Valve will automatically close and then open by itself. The Control Panel is programmed to run this cycle so that the valve continues to function properly in the event that it needs to shut off the water.
- Hanging Wires may be tied together using twist ties (Twist ties not provided).

13.

Troubleshooting

Problem	What to Check
Status light does not light	<ul style="list-style-type: none"> - Make sure there is power to the outlet. - Unplug AC Power Adaptor cord from Control Panel and plug back in. - If an AC Power Adaptor Extension Wire was used, unplug both ends and reconnect. - Make sure fresh batteries are in the Control Panel.
No water comes out of hot side of faucet	<ul style="list-style-type: none"> - Push Open button to make sure LeakSmart Valve is open. - Make sure the manual cold water valve is open. - Make sure a manual hot water valve was not accidentally closed.
No water comes out of hot or cold side of faucet	<ul style="list-style-type: none"> - Make sure main water shut-off valve is open.
LeakSmart Valve does not operate	<ul style="list-style-type: none"> - Make sure both sides of Leak Sensor are dry. - Make sure there is power to the outlet. - Unplug AC Power Adaptor cord from Control Panel and plug back in. <p>(continued)</p>

14.

Troubleshooting

Problem	What to Check
LeakSmart Valve does not operate (continued)	<ul style="list-style-type: none"> - Unplug 4-pin connector from Control Panel and reconnect. - Locate plug connection between Control Panel and LeakSmart Valve. Unplug the connection and reconnect, making sure arrows on side of plugs line up. - If an AC Power Adaptor Extension Wire was used, unplug both ends and reconnect. - Make sure fresh batteries are in the Control Panel.
Leak Sensor becomes wet but LeakSmart Valve does not close	<ul style="list-style-type: none"> - Unplug long flat wire from Leak Sensor and reconnect. - Make sure there is power to the outlet. - Unplug AC Power Adaptor cord from Control Panel and plug back in. - Unplug 4-pin connector from Control Panel and reconnect. <p>(continued)</p>

15.

Troubleshooting

Problem	What to Check
Leak Sensor becomes wet but LeakSmart Valve does not close (continued)	<ul style="list-style-type: none"> - Locate plug connection between Control Panel and LeakSmart Valve. Unplug the connection and reconnect, making sure arrows on the side of plugs line up. - If an AC Power Adaptor Extension Wire was used, unplug both ends and reconnect. - Make sure fresh batteries are in the Control Panel.
LeakSmart Valve closed but now will not open	<ul style="list-style-type: none"> - Make sure both sides of Leak Sensor are dry.
The alarm goes off for no apparent reason	<ul style="list-style-type: none"> - Leak Sensor is touching metal, or the concrete is sweating causing high humidity. Correct the problem by placing the paper sleeve on the Leak Sensor, or use a paper towel as a barrier.

16.

Manual Operation of LeakSmart Valve

1. Unplug the connection between the Control Panel and the LeakSmart Valve.
2. Pull the plastic motor cover off the LeakSmart Valve and slide it down the wire until it stops at the plug. Note that no tools are needed to remove the cover.
3. Use a marker and draw a line across the top of the plastic motor housing. This way once the motor is removed you will know how to reposition it for assembly.
4. Remove the 4 screws using a Phillips head screwdriver.
5. Place thumb and finger on plastic gear and rotate clockwise to open valve or counter clockwise to close it. Do not use tools to manually open or close valve.

17.

2 Year Limited Warranty

Waxman Consumer Products Group warrants the enclosed LeakSmart product to be free from defects in materials or workmanship, under normal use and service, for a period of two (2) years from the date of purchase. If at any time during the warranty period the product is determined to be defective, Waxman Consumer Products Group shall repair or replace it (at our option). The warranty is limited to defective parts as stated. All costs of removal and installation of the LeakSmart product, including the replacement of warranty parts, are the responsibility of the purchaser. The manufacturer shall not be liable for incidental, consequential, or special damages arising at, or in connection with product use or performance, except as may otherwise be accorded by law. Some states do not allow the exclusion limitation of incidental or consequential damages, so the limitation may not apply to you. Any damage to this LeakSmart product as a result of misuse, abuse, neglect, accident, improper installation, or any use violating the instruction manual furnished by us will void this warranty. This warranty does not cover damages or loss caused by defects, and the owner's use of the LeakSmart product confirms the understanding that this product does not constitute an insurance policy, and is only a loss mitigation product used to reduce the risk of water damage.

To obtain warranty service, call our Customer Service Department at 1-800-531-3342, or e-mail us at customerservice@waxmancp.com. You may also send the product and original dated receipt, prepaid US postage to: Waxman CPG, 24455 Aurora Road, Bedford Heights, Ohio 44146, Attention: Customer Service.

FCC Compliance

This equipment has been tested and found to comply with the limits for a Class B digital device, pursuant to part 15 of the FCC Rules. These limits are designed to provide reasonable protection against harmful interference in a residential installation. This equipment generates, uses and can radiate radio frequency energy, and if not installed and used in accordance with the instructions, may cause harmful interference to radio communications. However, there is no guarantee that interference will not occur in a particular installation. If this equipment does cause harmful interference to radio or television reception, which can be determined by turning the equipment off and on, the user is encouraged to try to correct the interference by one or more of the following measures:

- Reorient or relocate the receiving antenna.
- Increase the separation between the equipment and the receiver.
- Connect the equipment into an outlet on a circuit different from that to which the receiver is connected.
- Consult the dealer or an experienced radio/TV technician for help.

