

Tools Required

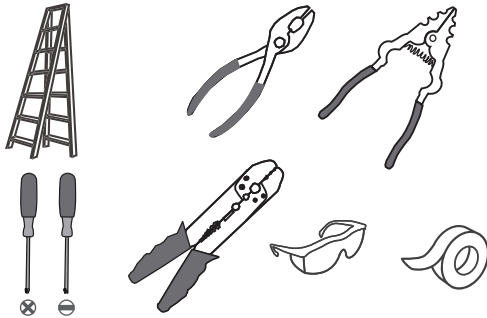

Light Source

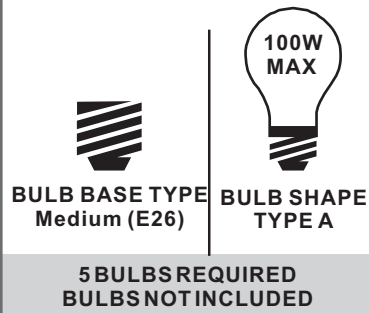

**Fixture Height Adjustable
24.5" to 74"**

⚠ Warnings and Cautions

Turn off the electricity at the circuit breaker before installation. Consult a licensed electrician if in doubt about installation.

Turn off power to the fixture and allow the bulbs to cool before replacing.

Package Contents

Preparation: Identify and inspect all parts before beginning the installation.

Missing or damaged parts? Contact your original place of purchase.

PARTS BAG

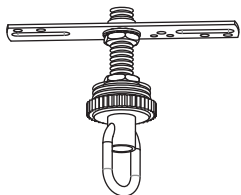

A Crossbar Assembly x 1



B Outlet Box Screw x 2



C Wire Connector x 3

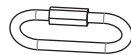

D Quick Link x 2



E Fixture Chain x 1

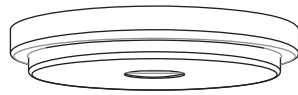

F Ceiling Canopy x 1



G Fixture Loop x 1

H Lock Screw x 4



J Socket Collar x 5

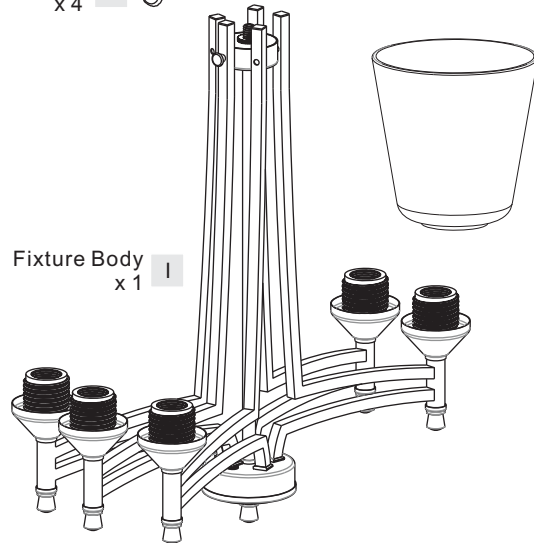

I Fixture Body x 1

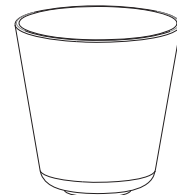

K Shade x 5

Table of Contents

Unfold arms & Fixture Loop

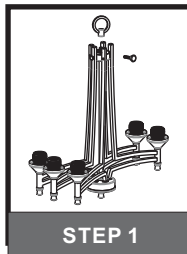

STEP 1

Crossbar Assembly

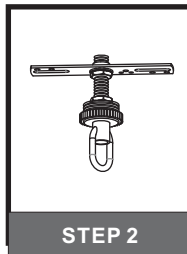

STEP 2

Fixture Chain

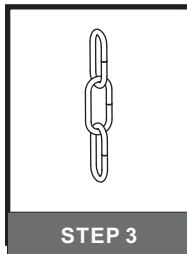

STEP 3

Wiring

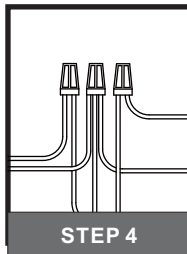

STEP 4

Ceiling Canopy

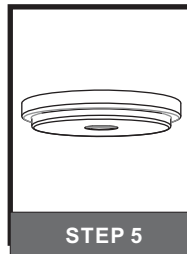

STEP 5

Shade & Bulb

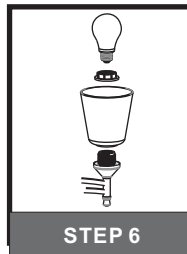

STEP 6

STEP 1

1

Unfold Support Arms

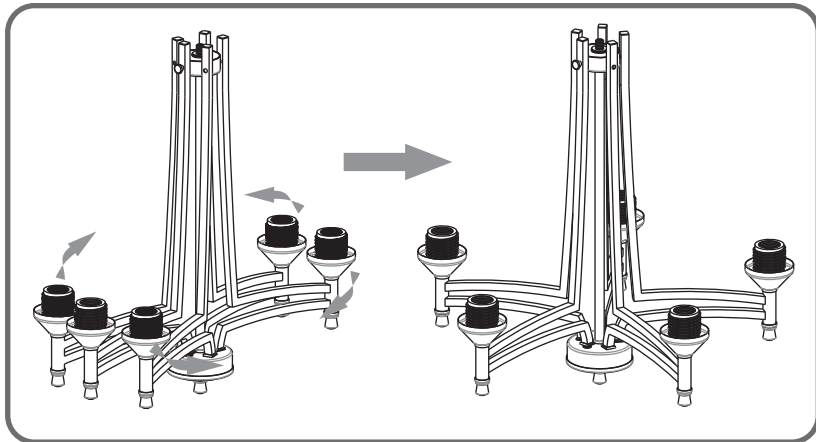

2

Install Lock Screws

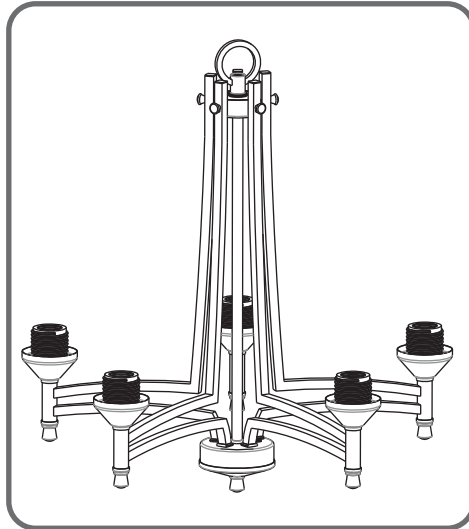
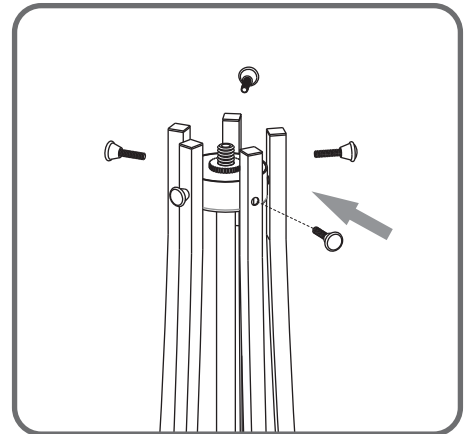

3

Install Fixture Loop

STEP 2

1

Step 1
Install crossbar assembly

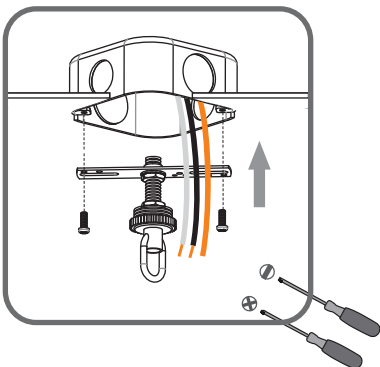

2

Step 2 - 3
Test fitting ceiling canopy to nipple

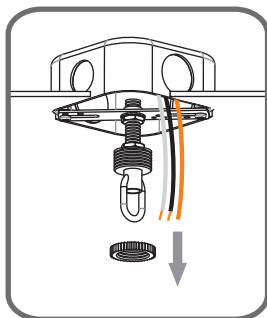

3

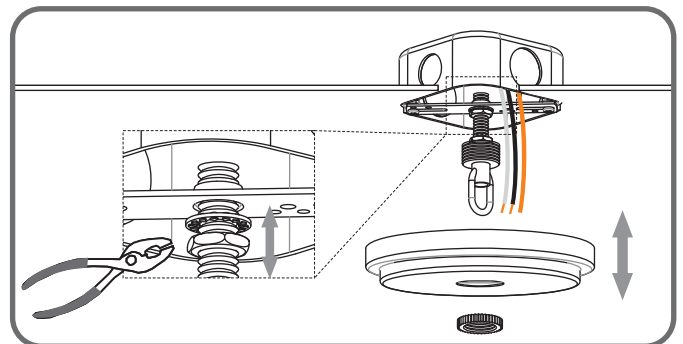

STEP 3

1

Step 1
Adjust fixture chain length

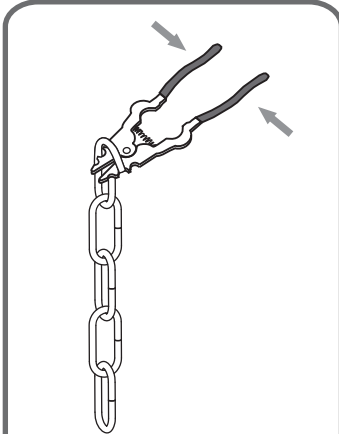

Suggested Chain Length:

- 8' ceiling: 10" Chain
- 9' ceiling: 22" Chain
- 10' ceiling: 34" Chain

2

Step 2 - 3
Install Fixture Chain

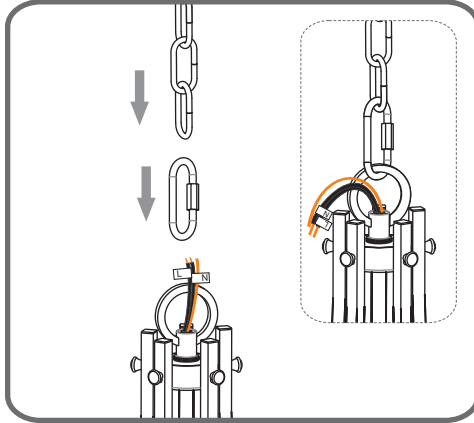

3

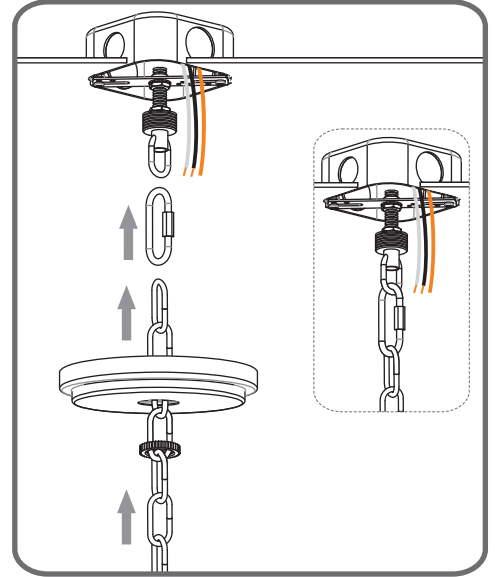

STEP 4

1

Step 1
Feed the fixture wires through the loop

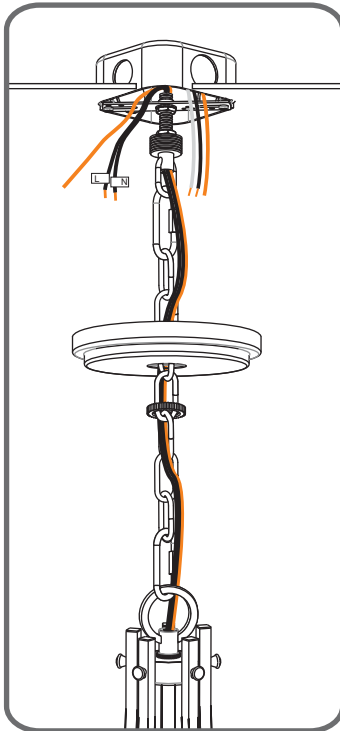

2

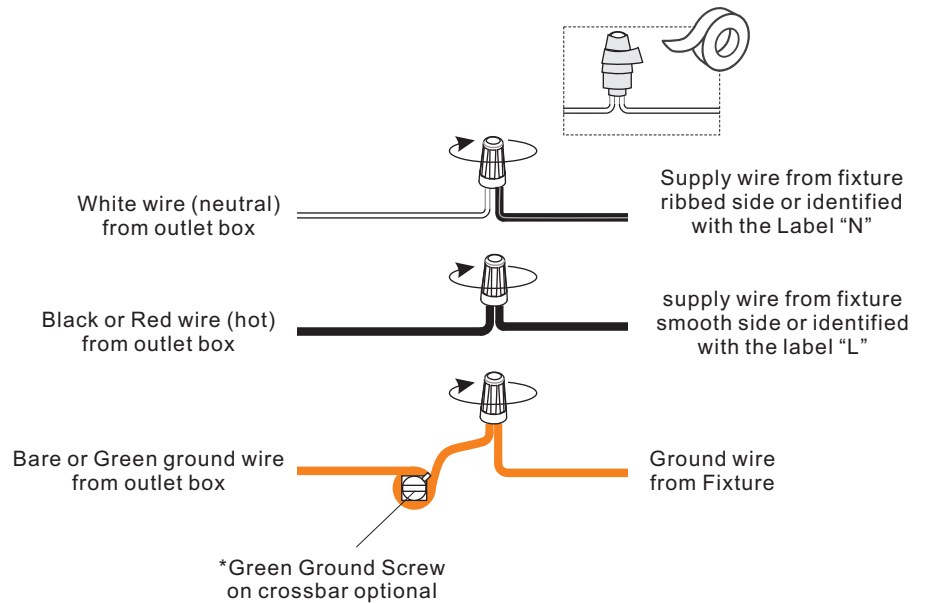

STEP 5

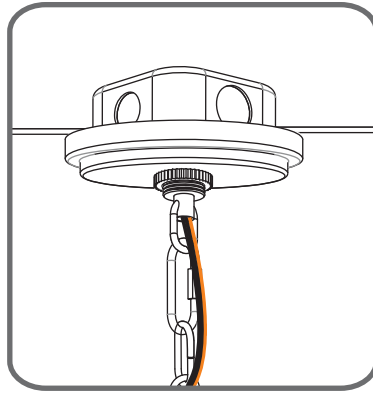
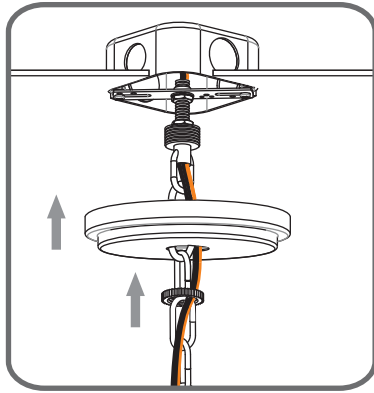

STEP 6

