

Stonington Large Pendant

CC1104, CC1114 1.0

GENERATION LIGHTING

Pendant

GENERAL PRODUCT INFORMATION:

These fixtures are intended to be installed utilizing NEC compliant junction boxes.

This product is safety listed for damp locations.

Incandescent lamps may be dimmed with a standard incandescent dimmer. LED lamps may be dimmed with a LED dimmer. Consult lamp manufacturer for additional information.

CAUTION - RISK OF FIRE

This product must be installed in accordance with the applicable installation code by a person familiar with the construction and operation of the product and the hazards involved.

Use minimum 90°C supply conductors.

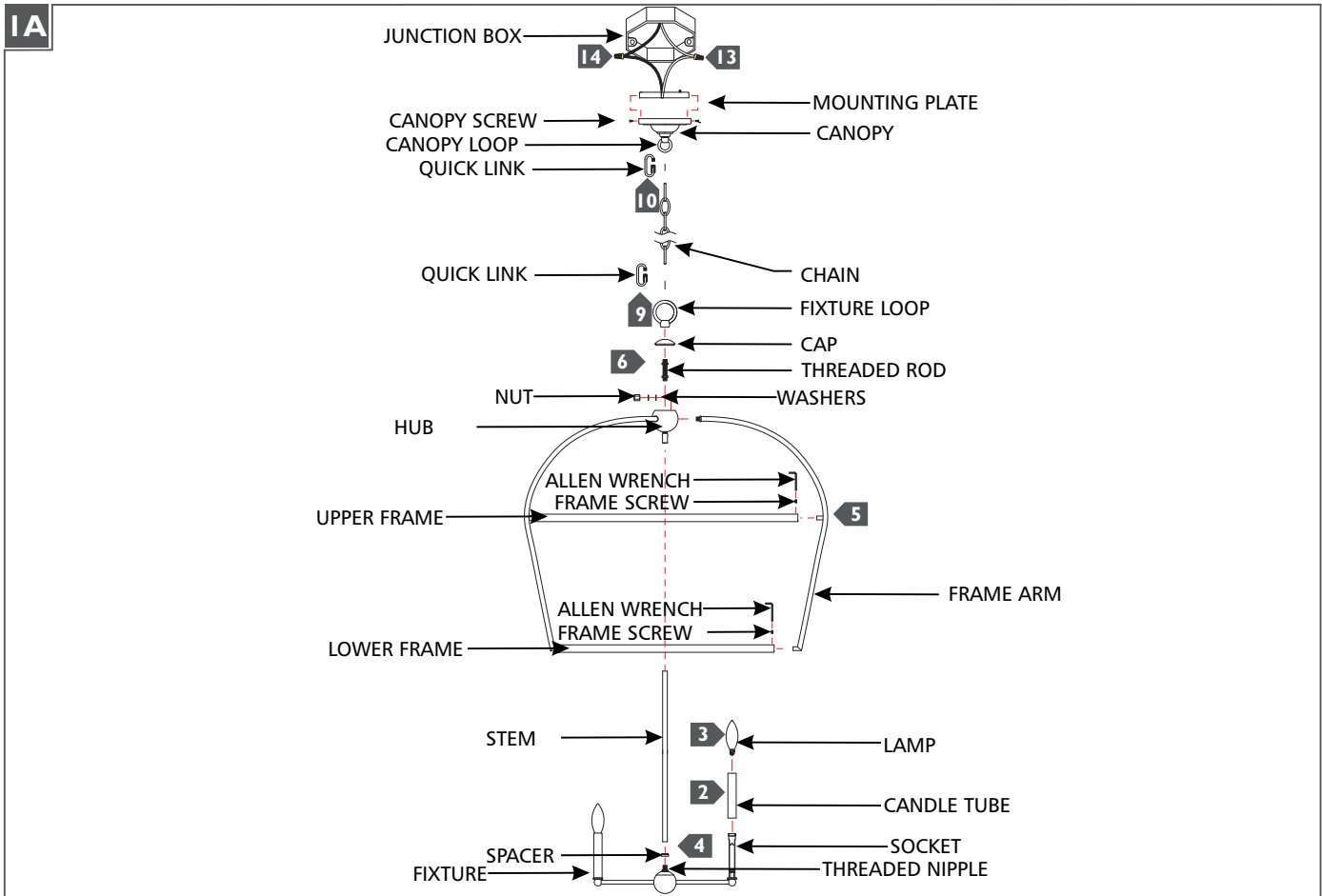

- 1** Secure the mounting plate to the junction box.
- 2** Install the candle tube by sliding it over the socket.
- 3** Screw the lamp into the socket. Refer to the label on the lamp socket for Max Wattage information.
- 4** Feed the cord through the spacer and stem and secure the stem to the fixture by screwing it on the threaded nipple.
- 5** Assemble the frame:
 - A.) Insert a frame arm into the hub and secure with two washers and a nut.
 - B.) Attach the lower frame with a frame screw and allen wrench.
 - C.) Attach the upper frame with a frame screw and allen wrench.
 - D.) Repeat steps A-C for the remaining four arms.
- 6** Feed the cord through the hub, threaded rod, cap and fixture loop, then screw the stem into the bottom of the hub.
- 7** screw the threaded rod into the hub then place the cap over the threaded nipple and secure by screwing the fixture loop onto threaded nipple.
- 8** Determine the wanted height of the fixture and remove a portion of the chain from the bottom by opening a link with pliers.
- 9** Install a quick link to bottom end of the chain, then secure the quick link onto the fixture loop.
- 10** Install the other quick link onto the remaining end of the chain, then secure the quick link onto the canopy loop.
- 11** Weave the cord through the chain, canopy and out of the junction box. Trim the cord leaving enough to make electrical connections.
- 12** Connect the fixture to a suitable ground in accordance to local electrical codes.
- 13** Connect the white fixture wire (square and/or rigid) to the neutral power line wire with a wire nut.
- 14** Connect the black fixture wire (round and/or smooth) to the hot power line wire with a wire nut.
- 15** Neatly place all the wires into the junction box, place the canopy onto the mounting plate, and secure it in place by using the provided canopy screws.

SAVE THESE INSTRUCTIONS!

GENERATION LIGHTING

7400 Linder Ave, Skokie, IL 160077
800.969.3347

www.generationlighting.com

© 2019 Generation Lighting. All rights reserved.
The "Generation Lighting" graphic is a registered trademark of
Generation Lighting. Generation Lighting reserves the right to
change specifications for product improvements without notification.