

NOTES:

(N1) 1. FIT / FORM / FUNCTION SHALL FOLLOW PS-E.008.

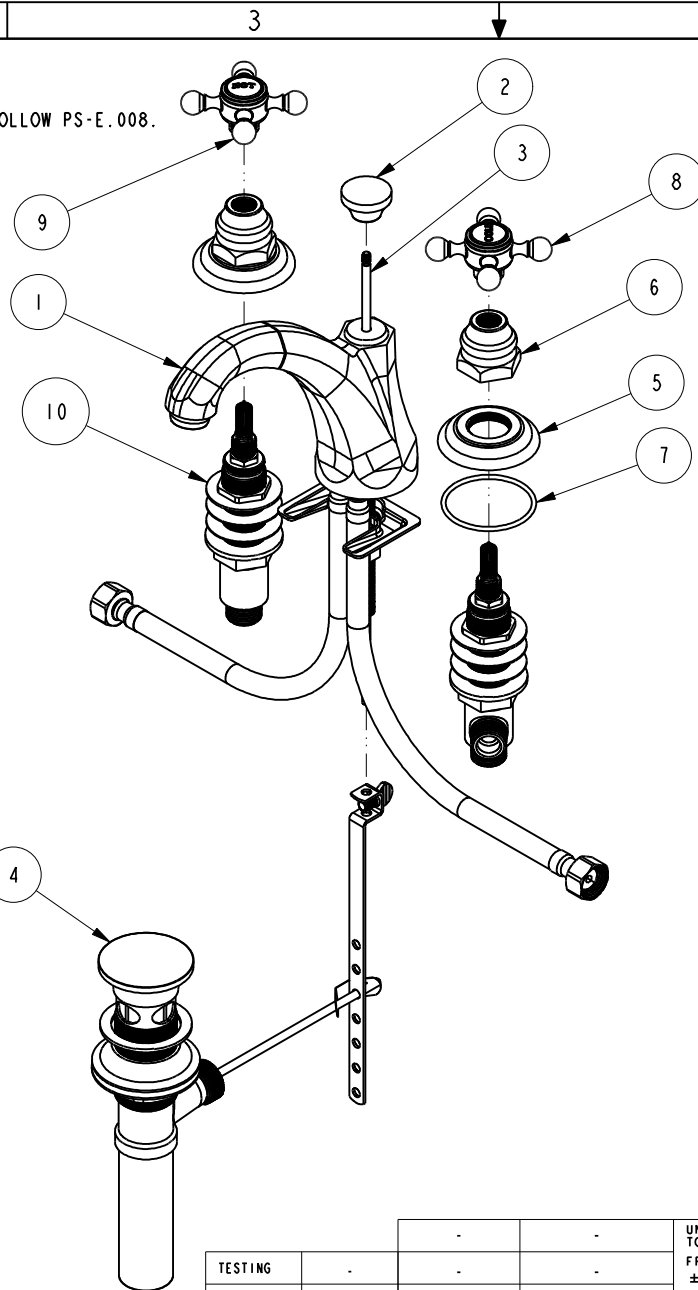

BILL OF MATERIAL (CURRENT LEVEL)

ITEM	PT/ASSY	DESCRIPTION	TYPE	QTY.
1	3-539	SPOUT ASM	ASSEMBLY	1
2	10961	SMOOTH POP - UP KNOB	PART	1
3	10288	3/16" POP UP ROD	PART	1
4	325	POP UP ASSEMBLY	ASSEMBLY	1
5	10048	ESCUTCHEON W/S VALVE	PART	2
6	10523	HEX ESCUTCHEON BONNET	PART	2
7	91231	O-RING, #2-136, EPDM, 65-75 DURO	PART	2
8	2-142	HANDLE ONLY, COLD	ASSEMBLY	1
9	2-141	HANDLE ONLY, HOT	ASSEMBLY	1
10	1-525	W/S VALVE ASM	ASSEMBLY	1

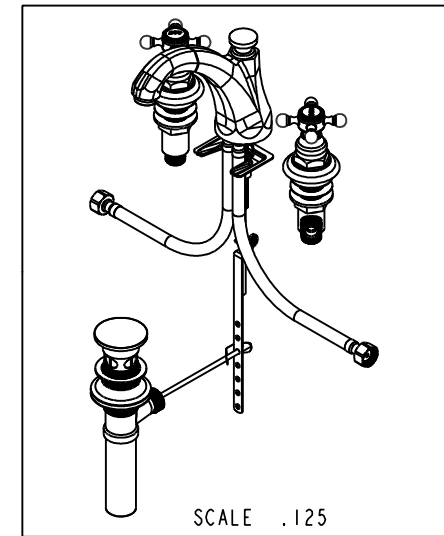

TESTING	-	-	-
ASSEMBLY	-	-	-
PLATING	-	-	-
POLISHING	-	NEXT ASSY	USED ON
MACHINING	-	APPLICATION	
TOOLING	FIXTURE #	REMOVE ALL BURRS AND SHARP EDGES	

UNITS ARE: INCHES [MM]
 TOLERANCES ARE:
 FRACTIONS DECIMALS ANGLES
 $\pm 1/16"$ $.x \pm .1$ [2,5] $\pm 1^\circ$
 $.xx \pm .06$ [1,5]
 (X.XXX) DENOTES CRITICAL DIMS.
 ALL THREADS ARE CRITICAL
 DRAWN VINAY 08/04/17
 CHECKED RAVINDRA 08/04/17
 APPROVED J.M 08/04/17

BRASSTECH 2001 CARNEGIE AVE.
 INCORPORATED SANTA ANA, CA 92705
 (949) 417-5207

WIDESPREAD FAUCET

DWG NO. 920C
 SCALE .225 REF. - SHEET 1 OF 2

REV	DESCRIPTION	DATE	APPROVED
B	EN-3371	08/04/17	J.M
A	EN-2832	11/06/14	-
-	EN-2781	08/18/14	-

COPYRIGHT 2005 BRASSTECH, INC.
 THESE DRAWINGS AND THE DESIGNS
 DEPICTED HEREIN ARE THE PROPRIETARY
 PROPERTY OF BRASSTECH. ANY USE
 OR REPRODUCTION IS SUBJECT TO
 THE EXPRESS APPROVAL OF BRASSTECH.
 UNAUTHORIZED USE IS STRICTLY
 PROHIBITED. ALL RIGHTS RESERVED.

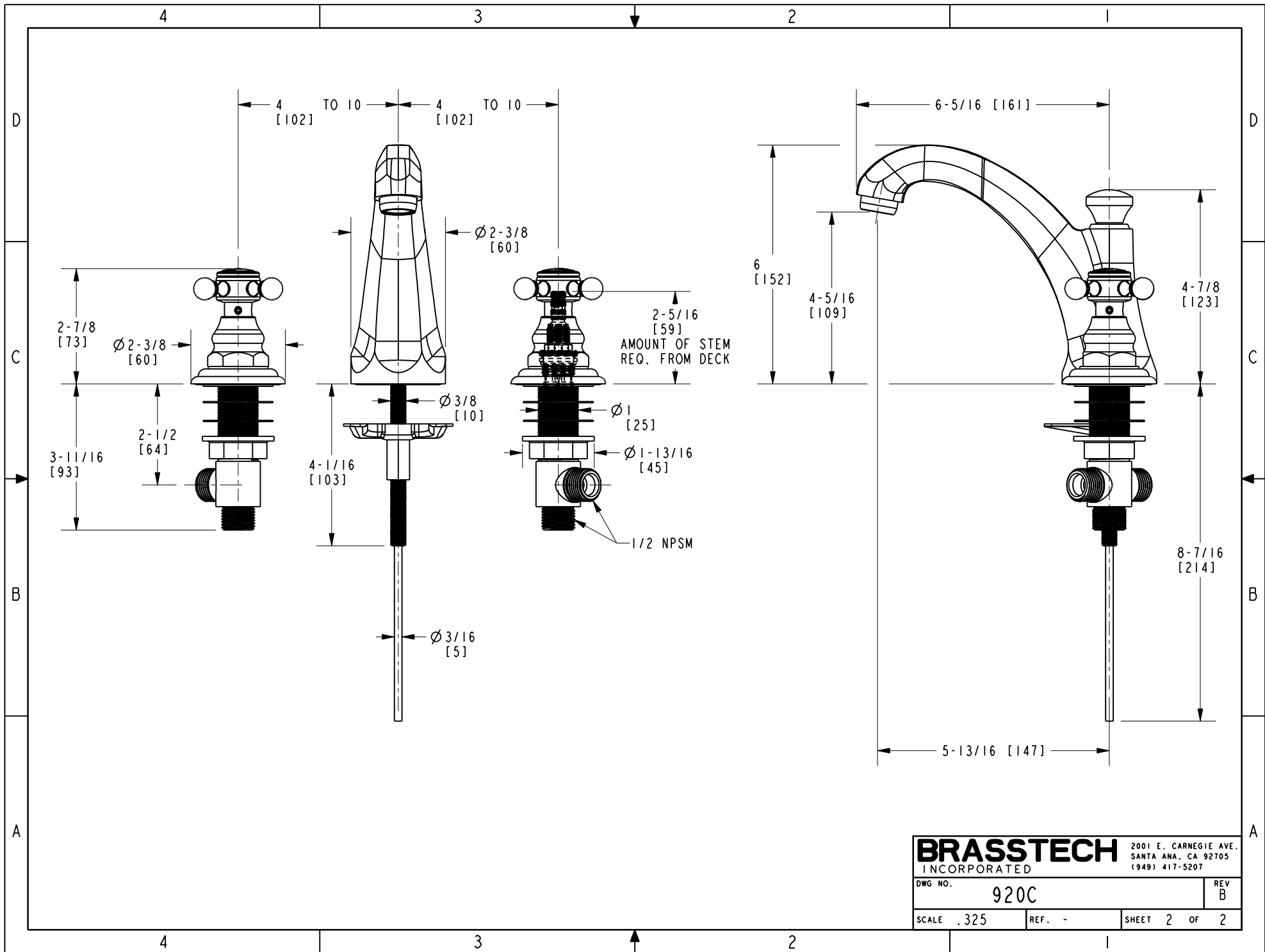

BRASSTECH		2001 E. CARNEGIE AVE.
INCORPORATED		SANTA ANA, CA 92705
		(949) 417-5207
DWG NO.	920C	REV B
SCALE .325	REF. -	SHEET 2 OF 2