

NOTES:

(NI) 1. FIT / FORM / FUNCTION SHALL FOLLOW PS-E.008.

BILL OF MATERIAL (CURRENT LEVEL)

| ITEM | PT/ASSY | DESCRIPTION | TYPE | QTY. |
|------|---------|----------------------------------|----------|------|
| 1 | 2-990 | TUB AND SHOWER PLATE ASM | ASSEMBLY | 1 |
| 2 | 2-989 | COLLAR ASM | ASSEMBLY | 1 |
| 3 | 91308 | TEMP LIMIT STOP - THERMO | PART | 1 |
| 4 | 12344 | HANDLE BONNET | PART | 1 |
| 5 | 12345 | SLEEVE - THERMO | PART | 1 |
| 6 | 2-991 | THERMO BONNET ASM | ASSEMBLY | 1 |
| 7 | 2-270 | THIN BLADE X-HANDLE - BLANK | ASSEMBLY | 2 |
| 8 | 92113 | SCRW, M4 X .7 X 40 PHL FLT HD SS | PART | 2 |

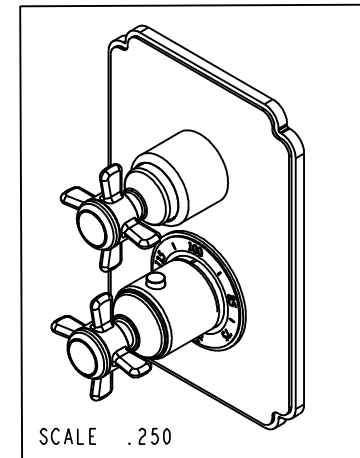
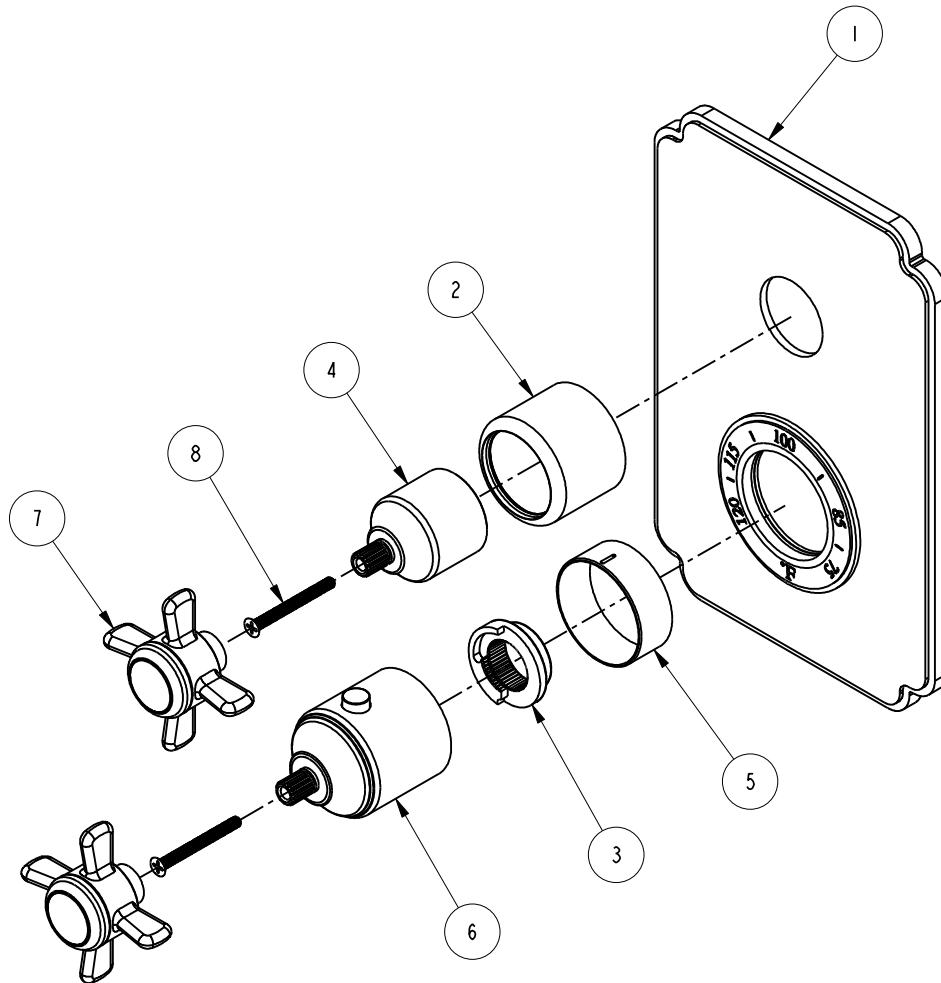

| | | | |
|-------------------|----------------------------------|-------------|---------|
| TESTING | - | - | - |
| ASSEMBLY | - | - | - |
| PLATING | - | - | - |
| POLISHING | - | NEXT ASSY | USED ON |
| MACHINING | - | APPLICATION | |
| TOOLING FIXTURE # | REMOVE ALL BURRS AND SHARP EDGES | | |

UNITS ARE: INCHES [MM]
 TOLERANCES ARE:
 FRACTIONS DECIMALS ANGLES
 $\pm 1/16''$.X $\pm .1$ [2,5] $\pm 1^\circ$
 .XX $\pm .06$ [1,5]
 (X.XXX) DENOTES CRITICAL DIMS.
 ALL THREADS ARE CRITICAL
 DRAWN AMARISH 01/17/17
 CHECKED RAVINDRA 01/17/17
 APPROVED R.S 01/17/17

BRASSTECH 2001 CARNEGIE AVE.
 INCORPORATED SANTA ANA, CA 92705
 (949) 417-5207

THERMO TUB / SHOWER

DWG NO. 3-1003TS REV A

SCALE .375 REF. - SHEET 1 OF 2

COPYRIGHT 2005 BRASSTECH, INC.
 THESE DRAWINGS AND THE DESIGNS
 DEPICTED HERE IN ARE THE PROPRIETARY
 PROPERTY OF BRASSTECH. ANY USE
 OR REPRODUCTION IS SUBJECT TO
 THE EXPRESS APPROVAL OF BRASSTECH.
 UNAUTHORIZED USE IS STRICTLY
 PROHIBITED. ALL RIGHTS RESERVED.

| - | A | EN-3236 | 01/17/17 | R.S |
|------|-----|-------------|----------|----------|
| - | - | EN-2775f | 08/20/15 | J.M. |
| ZONE | REV | DESCRIPTION | DATE | APPROVED |

