

NOTES:

- 1. FIT / FORM / FUNCTION SHALL FOLLOW PS-E.008.
- 2. APPLY LIGHT FILM OF DOW CORNING 111.
- 3. APPLY ADHESIVE LOCTITE 680.

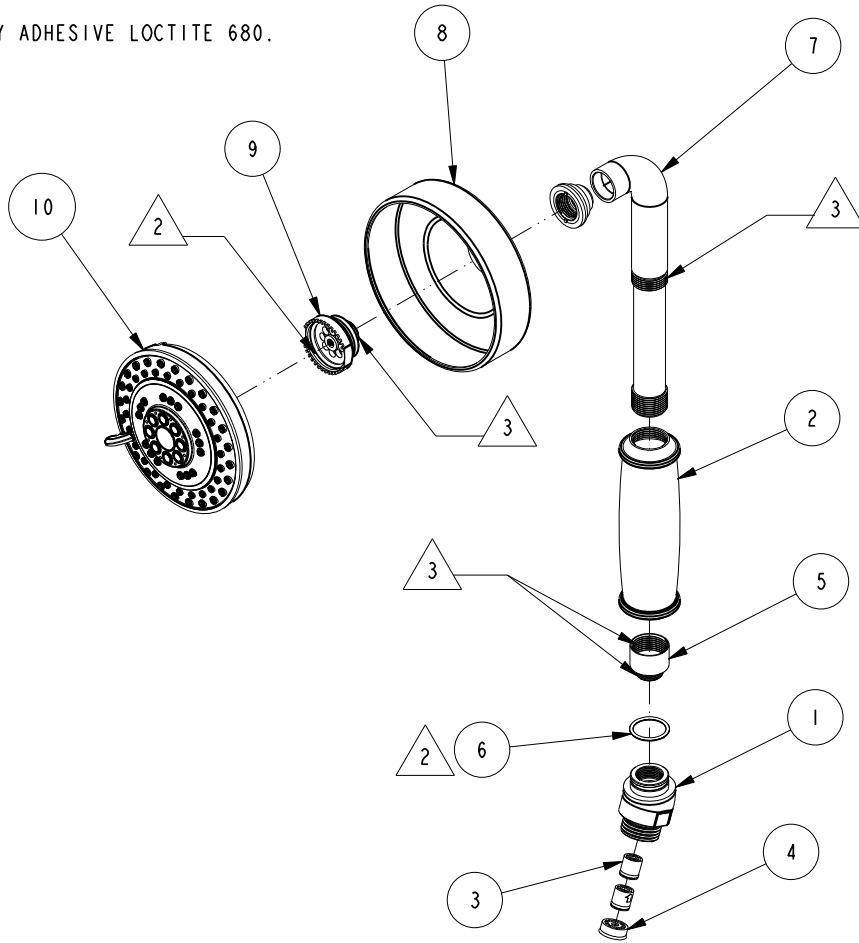

BILL OF MATERIAL (CURRENT LEVEL)

| ITEM | PT/ASSY | DESCRIPTION | TYPE | QTY. |
|------|---------|---|----------|------|
| 1 | 11562 | HAND SPRAY ELBOW END NUT | PART | 1 |
| 2 | 11373 | SLEEVE | PART | 1 |
| 3 | 5-050 | CHECK VALVE, NEOPERL DW10, WHITE | PART | 2 |
| 4 | 12832 | FLOW REGULATOR, 1.8 GPM MAX | PART | 1 |
| 5 | 92268 | HAND SHOWER ADAPTER | PART | 1 |
| 6 | 91021 | O-RING, #2- 017, EPDM, 65-75 DURO, NSF 61 | PART | 1 |
| 7 | 2-597 | TUBE ASSY | ASSEMBLY | 1 |
| 8 | 11375 | SHOWER HEAD SHELL | PART | 1 |
| 9 | 50784 | SHOWER HEAD ADAPTER | PART | 1 |
| 10 | 8-083 | SHOWER ENGINE | PART | 1 |

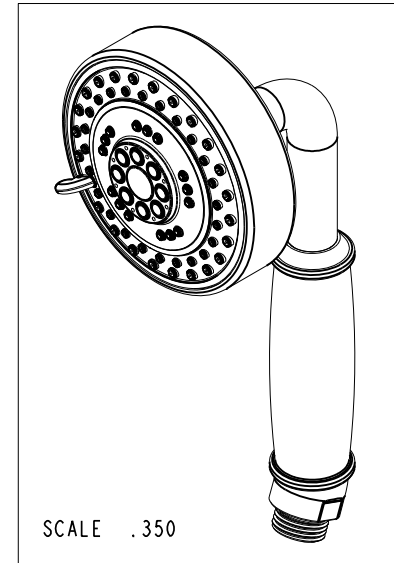

| ZONE | REV | DESCRIPTION | DATE | APPROVED |
|------|-----|-------------|----------|----------|
| - | E | EN-3553 | 03/22/18 | V.V. |
| - | D | EN-3410 | 01/01/18 | C.G. |
| - | C | EN-2768 | 06/19/14 | - |
| - | B | EN-1668 | 04/05/11 | - |
| - | A | EN-1265 | 10/22/09 | - |
| - | - | ECN-0940 | 02/11/08 | - |

COPYRIGHT 2005 BRASSTECH, INC. THESE DRAWINGS AND THE DESIGNS DEPICTED HEREIN ARE THE PROPRIETARY PROPERTY OF BRASSTECH. ANY USE OR REPRODUCTION IS SUBJECT TO THE EXPRESS APPROVAL OF BRASSTECH. UNAUTHORIZED USE IS STRICTLY PROHIBITED. ALL RIGHTS RESERVED.

| TESTING | ASSEMBLY | PLATING | POLISHING | MACHINING | TOOLING FIXTURE # |
|---------|----------|---------|-----------|-----------|----------------------------------|
| - | - | - | - | - | REMOVE ALL BURRS AND SHARP EDGES |

| UNITS ARE: | INCHES [MM] |
|---|-----------------|
| TOLERANCES ARE: | |
| FRACTIONS DECIMALS | ANGLES |
| ±1/16" | ±1° |
| .x ±.1 [2.5] | |
| .xx ±.06 [1.5] | |
| (X.XXX) DENOTES CRITICAL DIMS. ALL THREADS ARE CRITICAL | |
| DRAWN | JINSON 01/01/18 |
| CHECKED | C.G. 01/01/18 |
| APPROVED | C.G. 01/01/18 |

BRASSTECH 2001 CARNEGIE AVE. SANTA ANA, CA 92705 (949) 417-5207
INCORPORATED

HAND SHOWER - CONTEMPORARY

DWG NO. **283-3** REV **E**

SCALE .250 REF. - SHEET 1 OF 2

NOTE:
ASSEMBLE ENGINE IN THIS POSITION.

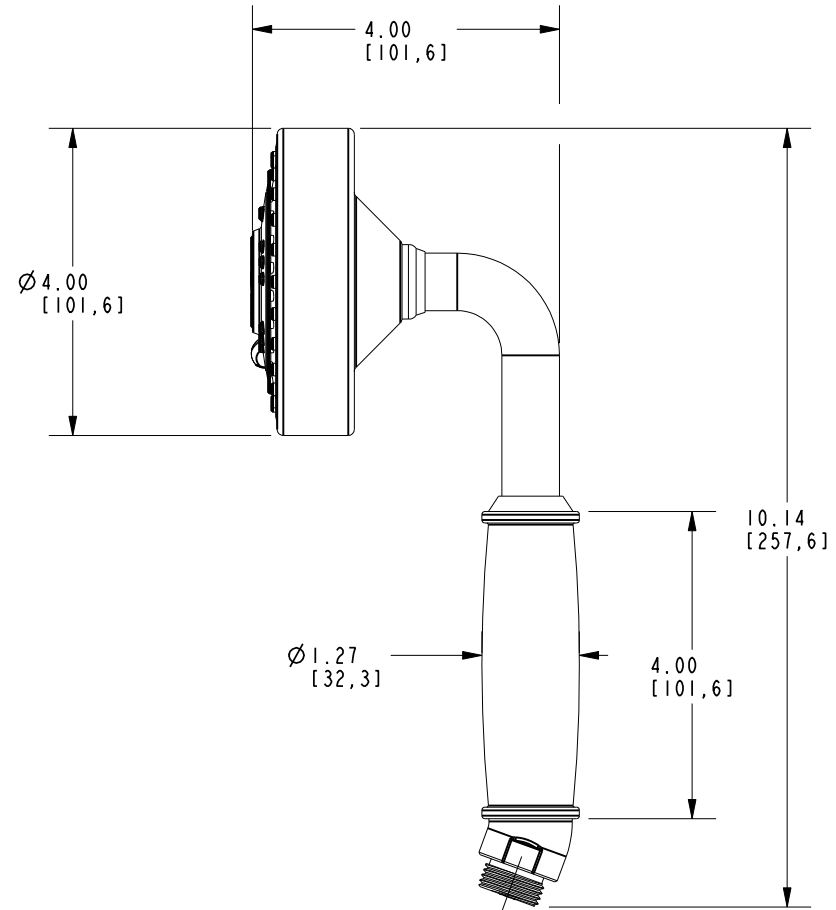
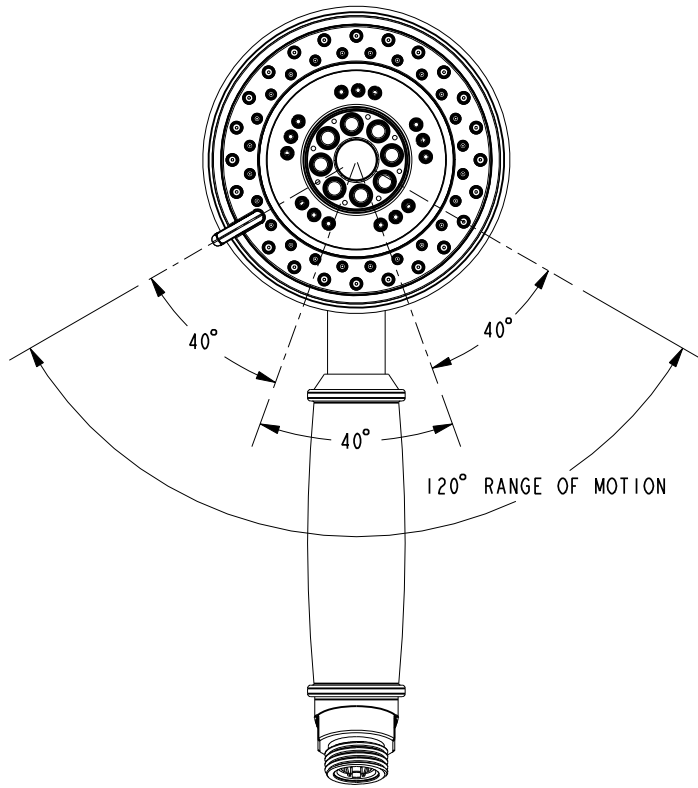

| | | | |
|------------------|--------|--|--|
| BRASSTECH | | 2001 E. CARNEGIE AVE. SANTA ANA, CA 92705 (949) 417-5207 | |
| INCORPORATED | | | |
| DWG NO. | 283-3 | REV E | |
| SCALE .400 | REF. - | SHEET 2 OF 2 | |