

BILL OF MATERIAL (CURRENT LEVEL)				
ITEM	PT/ASSY	DESCRIPTION	TYPE	QTY.
1	2-796	ESCUTCHEON- ASSEMBLY	ASSEMBLY	1
2	125-8	SOAP DISPENSER PUMP ASM	ASSEMBLY	1
3	125-9	SOAP DISPENSER BOTTLE	PART	1
4	2-797	SOAP PUMP HEAD ASSEMBLY	ASSEMBLY	1

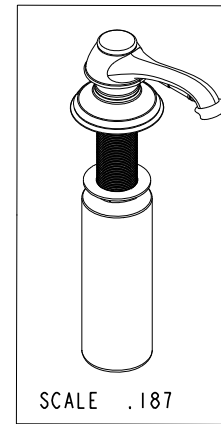
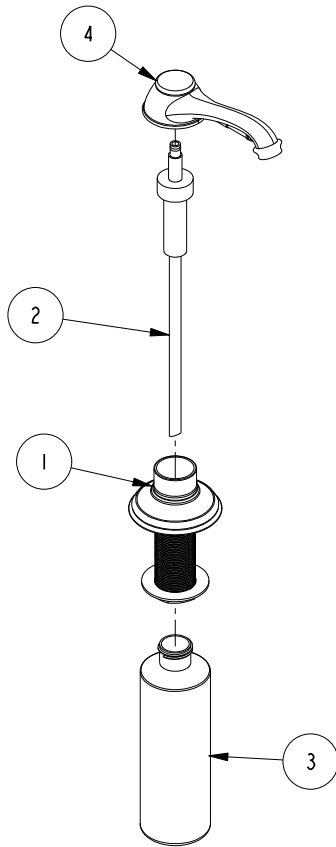

COPYRIGHT 2005 BRASSTECH, INC. THESE DRAWINGS AND THE DESIGNS DEPICTED HEREIN ARE THE PROPRIETARY PROPERTY OF BRASSTECH. ANY USE OR REPRODUCTION IS SUBJECT TO THE EXPRESS APPROVAL OF BRASSTECH. UNAUTHORIZED USE IS STRICTLY PROHIBITED. ALL RIGHTS RESERVED.

BRASSTECH
INCORPORATED
2001 E. CARNEGIE AVE.
SANTA ANA, CA 92705
(949) 417-5207

JACOBAN SOAP DISPENSER

ASSY. NO. 2470-5721		A	EN-1552-4 A	09/15/11
SCALE .187	REF. -	-	EN-1552-4	05/24/11
SHEET 1 OF 2		REV	REV DESC	DATE

SPECIFICATION DWG

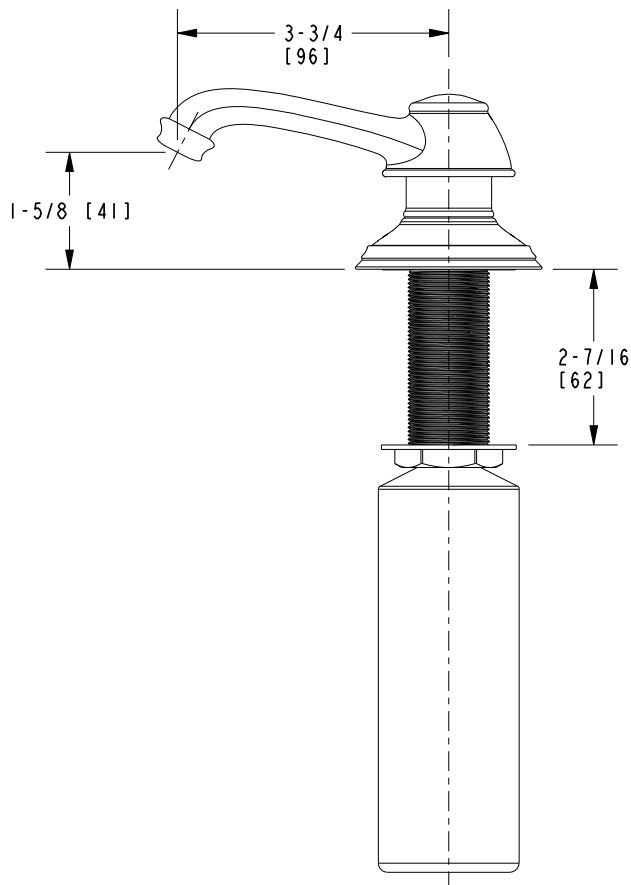
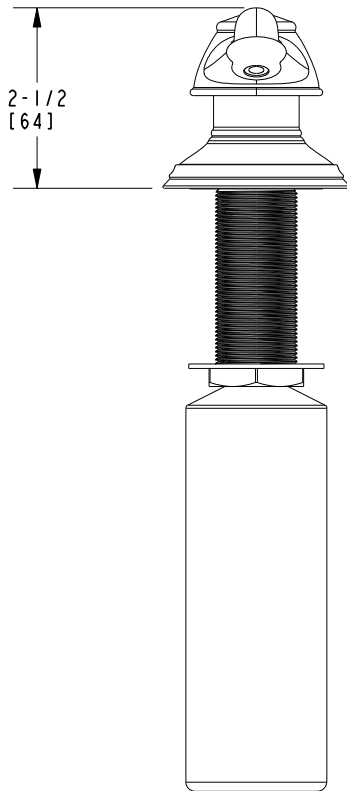
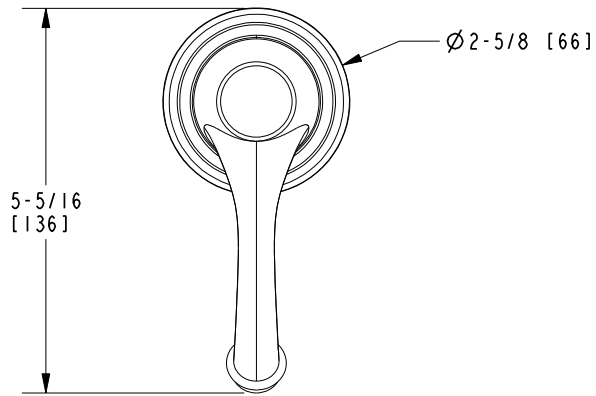

DIMENSIONS ARE IN INCHES AND AN APPROXIMATION OF A TYPICAL INSTALLATION

COPYRIGHT 2005 BRASSTECH, INC. THESE DRAWINGS AND THE DESIGNS DEPICTED HEREIN ARE THE PROPRIETARY PROPERTY OF BRASSTECH. ANY USE OR REPRODUCTION IS SUBJECT TO THE EXPRESS APPROVAL OF BRASSTECH. UNAUTHORIZED USE IS STRICTLY PROHIBITED. ALL RIGHTS RESERVED.

BRASSTECH		2001 E. CARNEGIE AVE.	
INCORPORATED		SANTA ANA, CA 92705	
		(949) 417-5207	
DWG NO.	2470-5721	REV	A
SCALE	.375	REF.	-
		SHEET	2 OF 2