

NOTES:

- (NI) 1. FIT / FORM / FUNCTION SHALL FOLLOW PS-E.008.
- 2. APPLY 50-60 LB-IN OF TORQUE

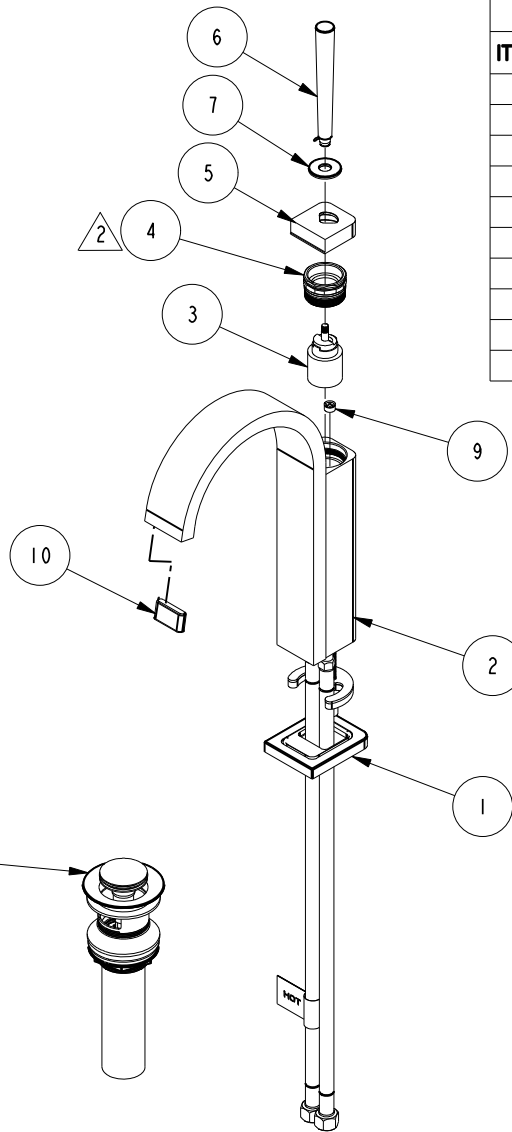

BILL OF MATERIAL (CURRENT LEVEL)

ITEM	PT/ASSY	DESCRIPTION	TYPE	QTY.
1	2-917	ESCUTCHEON ASM	ASSEMBLY	1
2	3-456	SPOUT ASM	ASSEMBLY	1
3	1-298	CATRIDGE - F25S	ASSEMBLY	1
4	1-295	RETAINER NUT ASM	ASSEMBLY	1
5	12161	DECORATIVE CAP	PART	1
6	12162	CONICAL LEVER	PART	1
7	12223	FLOATING DISC	PART	1
8	330	DRAIN, PUSH DOWN, W/ OVERFLOW	ASSEMBLY	1
9	12401	FLOW REGULATOR, 1.2 GPM, PINK	PART	1
10	91567	FLOW STRAIGHTENER 28 X 7, NEOPERL- 02.3295.0	PART	1

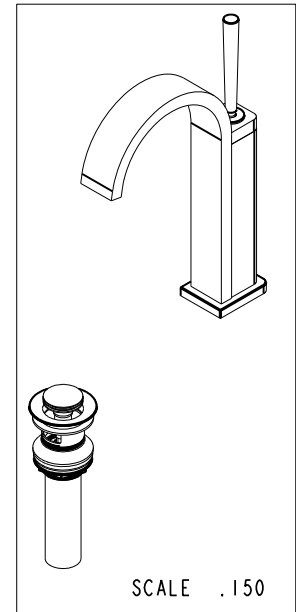

TESTING	-	-	-
ASSEMBLY	-	-	-
PLATING	-	-	-
POLISHING	-	NEXT ASSY	USED ON
MACHINING	-	APPLICATION	
TOOLING FIXTURE #		REMOVE ALL BURRS AND SHARP EDGES	

UNITS ARE: INCHES [MM]
TOLERANCES ARE:
FRACTIONS DECIMALS ANGLES
±1/16" .X ±.1 [2.5] ±1°
.XX ±.06 [1.5]

(X.XXX) DENOTES CRITICAL DIMS.
ALL THREADS ARE CRITICAL

DRAWN	R.S.	11/04/14
CHECKED	J.M.	11/04/14
APPROVED	J.M.	11/04/14

BRASSTECH 2001 CARNEGIE AVE.
INCORPORATED SANTA ANA, CA 92705
(949) 417-5207

SECANT - SINGLE HOLE FAUCET

DWG NO. **2043** REV B

SCALE .180 REF. - SHEET 1 OF 2

-	B	EN-3718	10/01/18	C.G.	COPYRIGHT 2005 BRASSTECH, INC. THESE DRAWINGS AND THE DESIGNS DEPICTED HEREIN ARE THE PROPRIETARY PROPERTY OF BRASSTECH. ANY USE OR REPRODUCTION IS SUBJECT TO THE EXPRESS APPROVAL OF BRASSTECH. UNAUTHORIZED USE IS STRICTLY PROHIBITED. ALL RIGHTS RESERVED.
-	A	EN-2896d	06/22/16	V.V.	
-	-	EN-2291	09/13/13	J.M.	
ZONE	REV	DESCRIPTION	DATE	APPROVED	

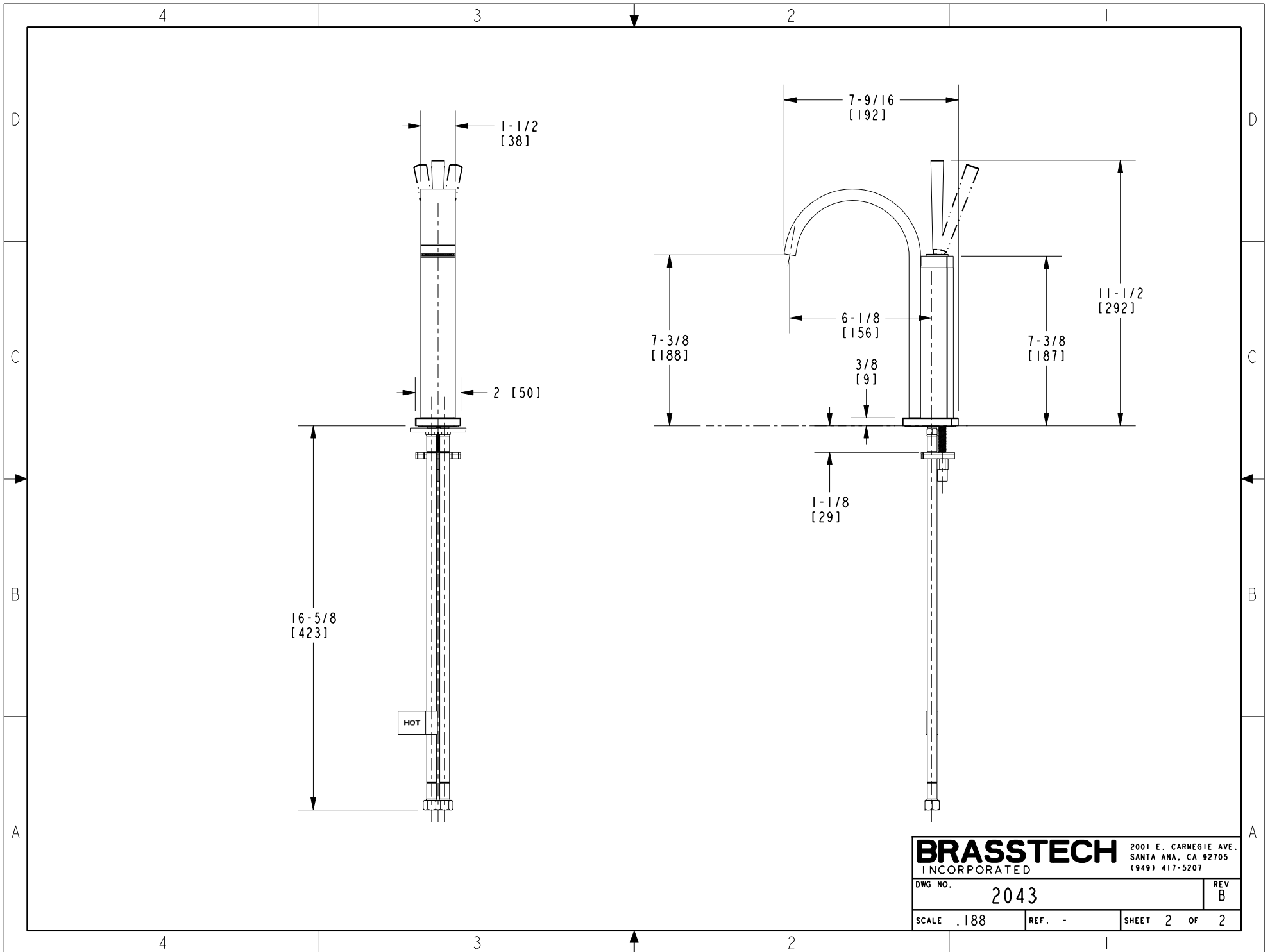

BRASSTECH		2001 E. CARNEGIE AVE.	
INCORPORATED		SANTA ANA, CA 92705	
DWG NO. 2043		REV B	
SCALE .188	REF. -	SHEET 2 OF 2	