

4

3

2

1

1 VALVE SHOWN WITH TORO-ABLE CARTRIDGES THAT ARE SUPPLIED WITH TRIM KIT. THESE CARTRIDGES MUST BE USED TO REPLACE CARTRIDGES THAT ARE SUPPLIED WITH THE VALVE. TORQUE TO 14-16 FT-LBS.

2 RECOMMENDED VALVE(S), SHOWN WITH TRIM KIT, SOLD SEPERATELY.

**BILL OF MATERIAL (CURRENT LEVEL)**

ITEM	PT/ASSY	DESCRIPTION	TYPE	QTY.
1	1-500	T/S 2 - VALVE ROUGH	ASSEMBLY	1
2	3-1775	TUB TRIM, LEVER HANDLE, 3-1775	ASSEMBLY	1

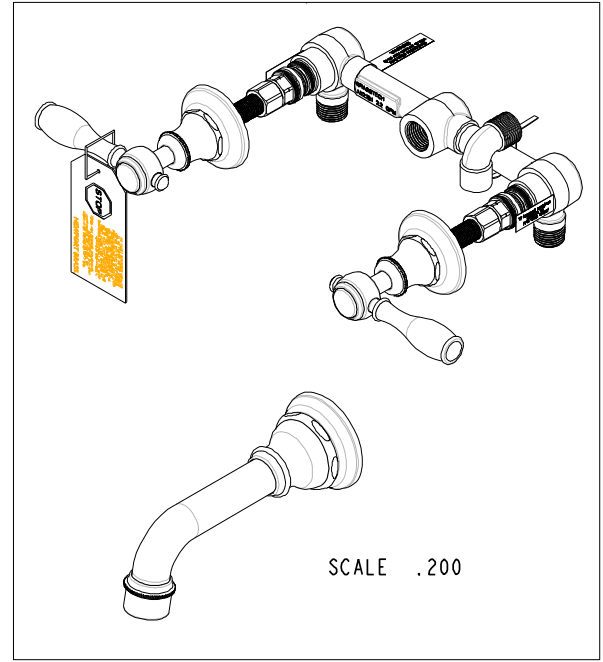
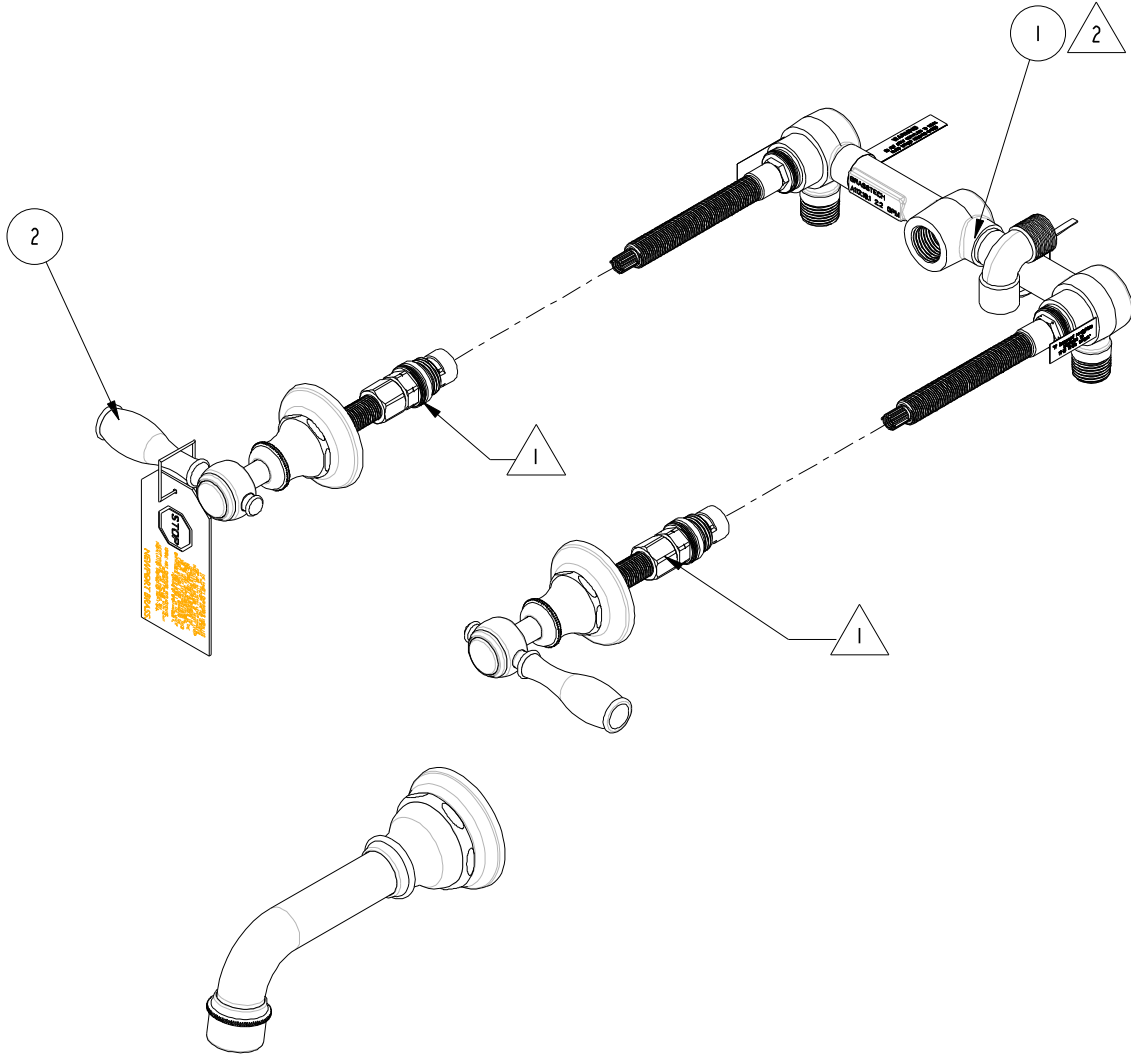

COPYRIGHT 2005 BRASSTECH, INC. THESE DRAWINGS AND THE DESIGNS DEPICTED HEREIN ARE THE PROPRIETARY PROPERTY OF BRASSTECH. ANY USE OR REPRODUCTION IS SUBJECT TO THE EXPRESS APPROVAL OF BRASSTECH. UNAUTHORIZED USE IS STRICTLY PROHIBITED. ALL RIGHTS RESERVED.

**BRASSTECH**  
INCORPORATED

2001 E. CARNEGIE AVE.  
SANTA ANA, CA 92705  
(949) 417-5207

TUB TRIM W/ LEVER HANDLES

ASSY. NO. 1775

SCALE .250

REF. -

SHEET 1 OF 3

A	EN-1176	10/23/09
-	EO-0744	07/14/06
REV	REV DESC	DATE

4

3

2

1

1 VALVE SHOWN WITH TORQ-ABLE CARTRIDGES THAT ARE SUPPLIED WITH TRIM KIT. THESE CARTRIDGES MUST BE USED TO REPLACE CARTRIDGES THAT ARE SUPPLIED WITH THE VALVE. TORQUE TO 14-16 FT-LBS.

BILL OF MATERIAL (CURRENT LEVEL)				
ITEM	PT/ASSY	DESCRIPTION	TYPE	QTY.
1	3-323	LEVER HANDLE ASSEMBLY	ASSEMBLY	2
2	2-560	TUB SPOUT ESCUTCHEON ASM	ASSEMBLY	1
3	3-298	TUB SPOUT ASM	ASSEMBLY	1
4	1-164	WALL MOUNT OICK CONNECT ASM	ASSEMBLY	1
5	1-543	T/S TORQ. CARTRIDGE COLD	ASSEMBLY	1
6	1-544	T/S TORQ. CARTRIDGE HOT	ASSEMBLY	1
7	98062	PRODUCT WARNING LABEL	PART	1

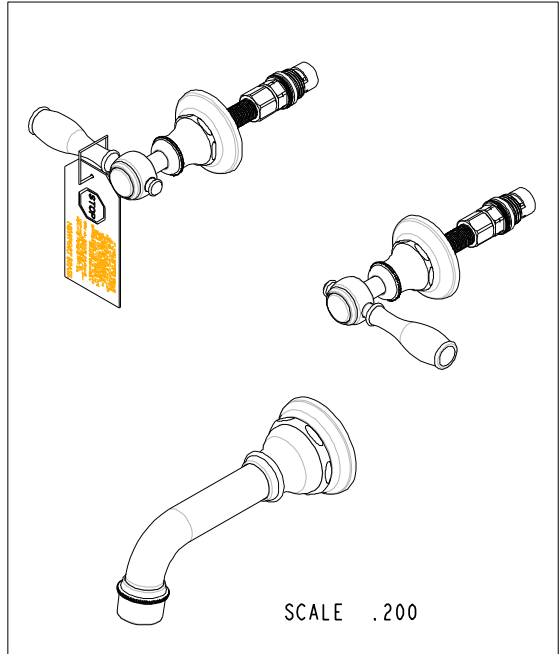
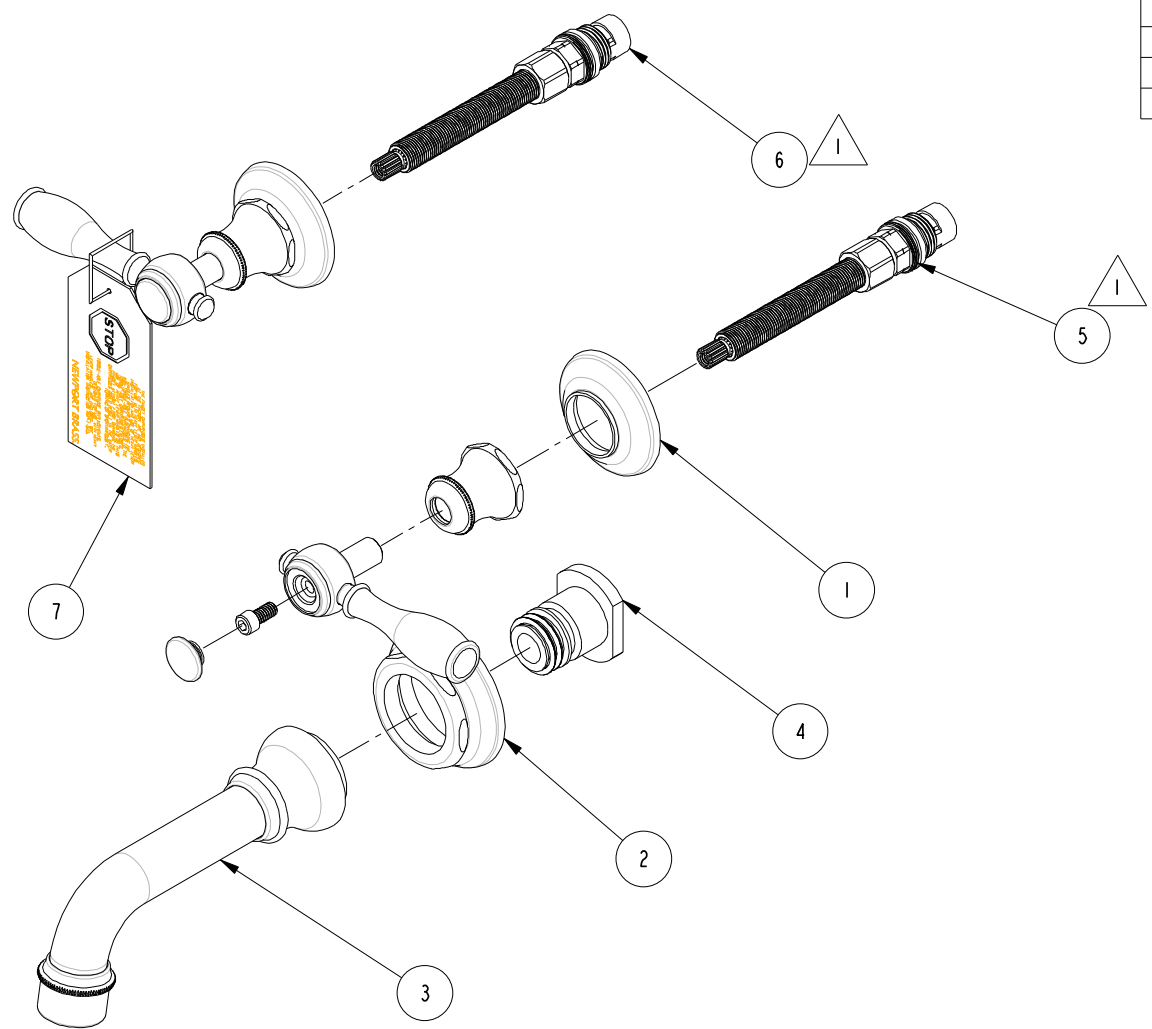

COPYRIGHT 2005 BRASSTECH, INC. THESE DRAWINGS AND THE DESIGNS DEPICTED HEREIN ARE THE PROPRIETARY PROPERTY OF BRASSTECH. ANY USE OR REPRODUCTION IS SUBJECT TO THE EXPRESS APPROVAL OF BRASSTECH. UNAUTHORIZED USE IS STRICTLY PROHIBITED. ALL RIGHTS RESERVED.

**BRASSTECH**  
INCORPORATED  
2001 E. CARNEGIE AVE.  
SANTA ANA, CA 92705  
(949) 417-5207

TUB TRIM, LEVER HANDLE, 3-1775

ASSY. NO.	1775	A	EN-1176	10/23/09
SCALE	.300	REF.	-	EO-0744
SHEET	2	OF	3	07/14/06
REV		REV	DESC	DATE

**SPECIFICATION DWG**

NOTES:  
1. CUT ALL - THREAD 1/2" SHORTER THAN STEM.

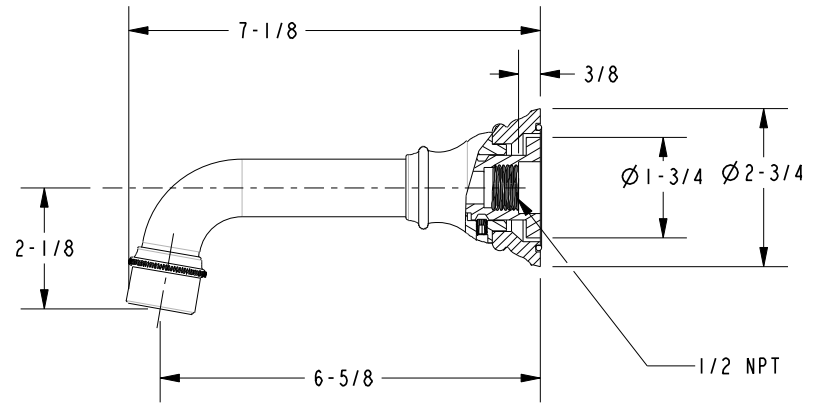
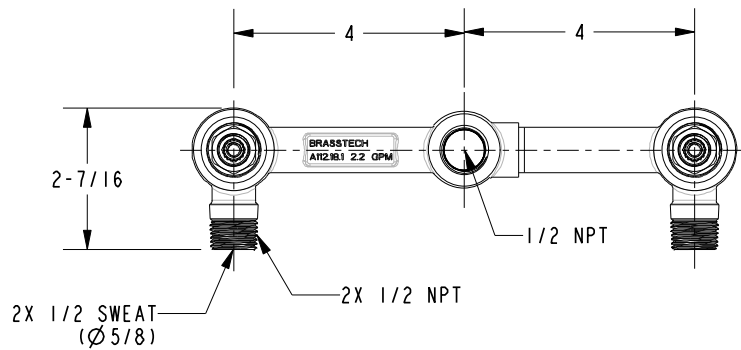
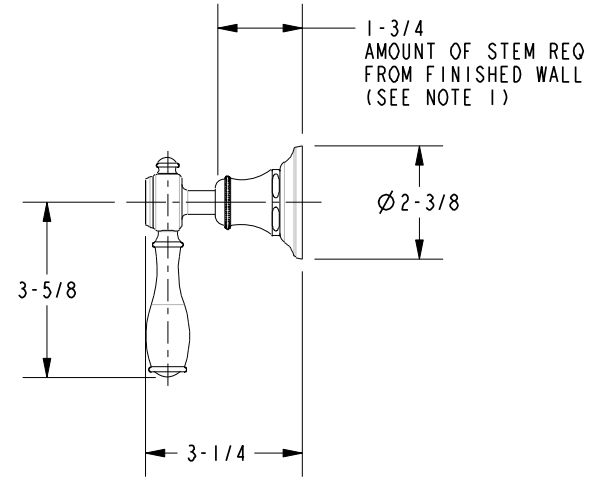
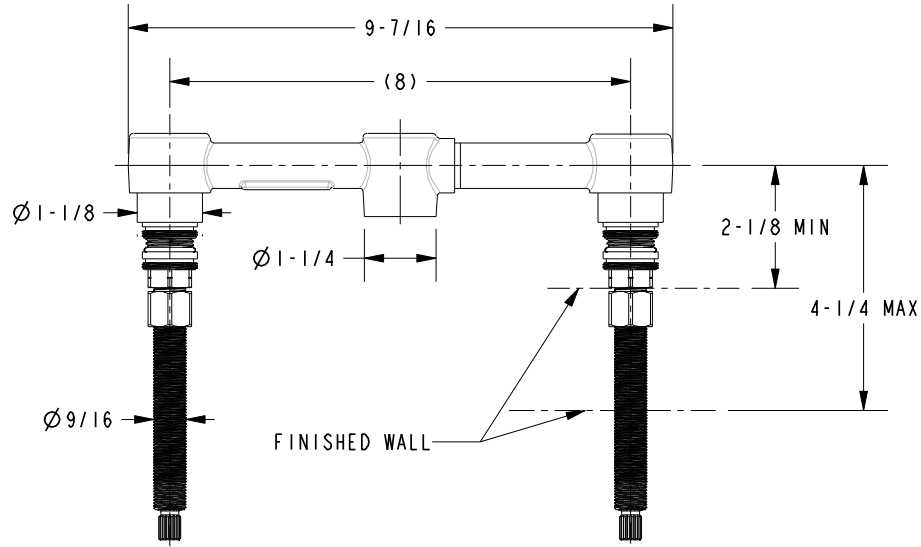

DIMENSIONS ARE IN INCHES AND AN APPROXIMATION OF A TYPICAL INSTALLATION

COPYRIGHT 2005 BRASSTECH, INC. THESE DRAWINGS AND THE DESIGNS DEPICTED HEREIN ARE THE PROPRIETARY PROPERTY OF BRASSTECH. ANY USE OR REPRODUCTION IS SUBJECT TO THE EXPRESS APPROVAL OF BRASSTECH. UNAUTHORIZED USE IS STRICTLY PROHIBITED. ALL RIGHTS RESERVED.

<b>BRASSTECH</b>		2001 E. CARNEGIE AVE.	
INCORPORATED		SANTA ANA, CA 92705	
		(949) 417-5207	
DWG NO.	1775	REV	A
SCALE	.300	REF.	-
		SHEET	3 OF 3